



- Facade LITE

Plug & Power Up! - As easy as it sounds

Mitrex eFacade LITE BIM
Catalog Manual

 MITREX™

mitrex.com





eFacade LITE Product Introduction

eFacade LITE by Mitrex is a pre-engineered solar facade system with advanced building-integrated photovoltaic technology (BIPV) created to accelerate solar adoption without compromising performance. A ventilated rainscreen system with a hidden extruded aluminum profile encasing a layer of high-efficiency solar cells and a glass facing, each panel is a powerhouse of energy.

Designed for projects seeking rapid deployment, lower costs, and simplified electrical integration, LITE panels feature a built-in PowerBar that enables plug-and-play wiring on site. With two panel sizes and five color options, eFacade LITE delivers energy performance in a system that's optimized for streamlined delivery and long-term durability. It's the ideal solution for retrofit projects, budget-conscious developments, or buildings that require simplicity and speed.

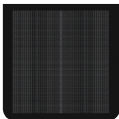
Module Colour Options

Mitrex eFacade LITE is available in five clean, neutral color tones to blend with any project. These curated options are designed to complement a wide range of architectural materials such as aluminum panels, GFRC, EIFS, and ACM. Whether your design calls for a bold contrast or understated elegance, LITE's palette offers the flexibility to enhance visual cohesion across facades.

				
Core Black	Blackout	Nobel Grey	Storm Grey	Cassia
⚡ 18W/SQFT	⚡ 16W/SQFT	⚡ 10W/SQFT	⚡ 13W/SQFT	⚡ 14W/SQFT
⚡ 2.5 kW*	⚡ 2.2 kW*	⚡ 1.3 kW*	⚡ 1.8 kW*	⚡ 2.0 kW*

*These system sizes are based on one standard package consisting of 150 SQFT.

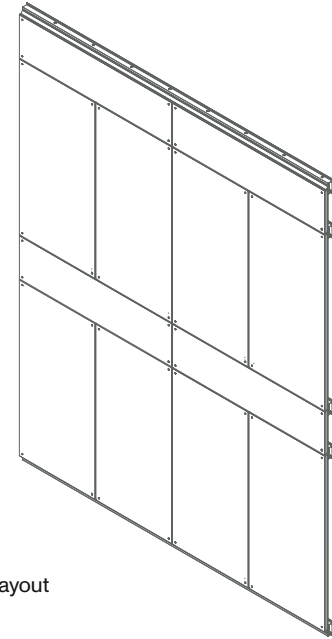
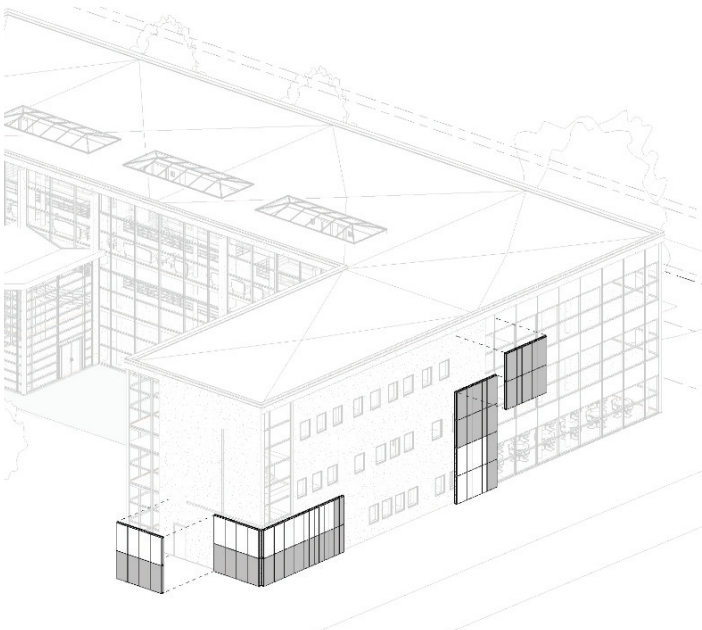

• eFacade LITE Sample Layout

Module Size Capabilities

Mitrex eFacade LITE offers two standard sizes that can be seamlessly integrated with other modules of the same size or between the two sizes.

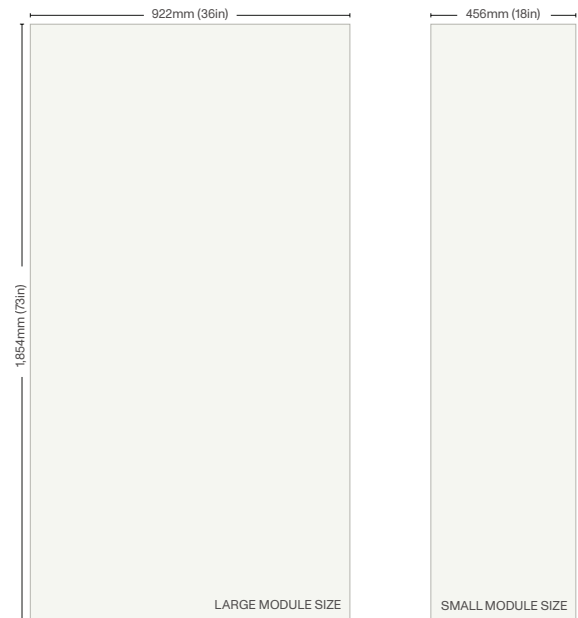

Download the BIM catalogue [HERE](#) or scan the QR code below

eFacade LITE Design Tools for BIM

Mitrex has developed a Revit tool to simplify the integration of eFacade LITE into any architectural facade design. With customizable Revit Families available as Generic Models and Curtain Panels, users can easily apply eFacade LITE panels, adjust materials, and generate project schedules directly within Revit.

eFacade L Revit file name: Revit Library.rvt

Tools Included in Revit Library

Family 1: Generic Model Family

This category is an independent family type that can be directly applied to the Revit project.

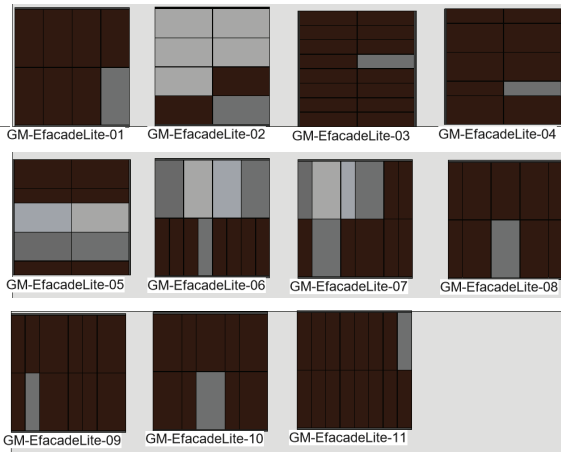

Family 2: Curtain Panel Family

This category must be hosted by a curtain wall within the Revit project.

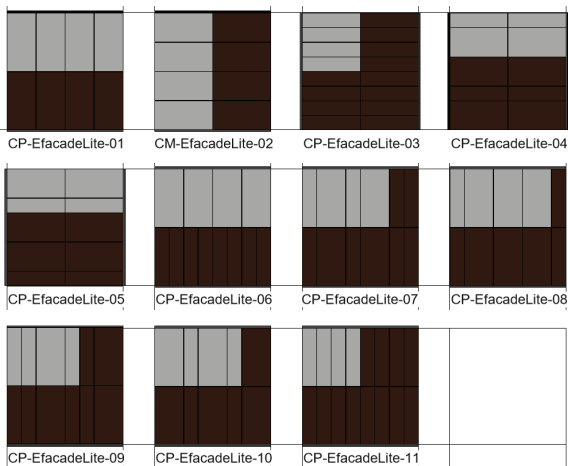

▶ Take a look at Video -01

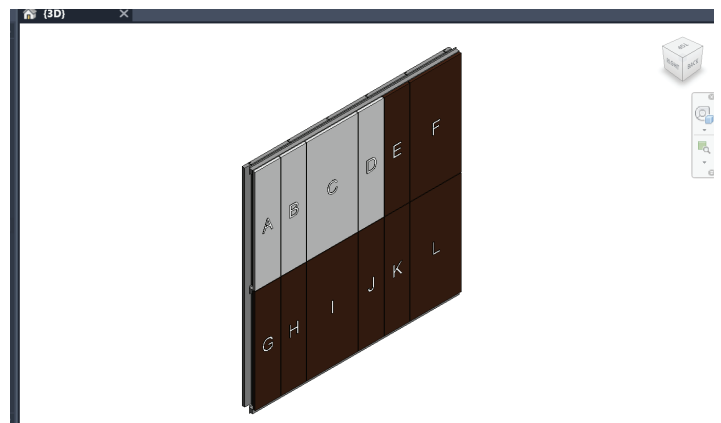
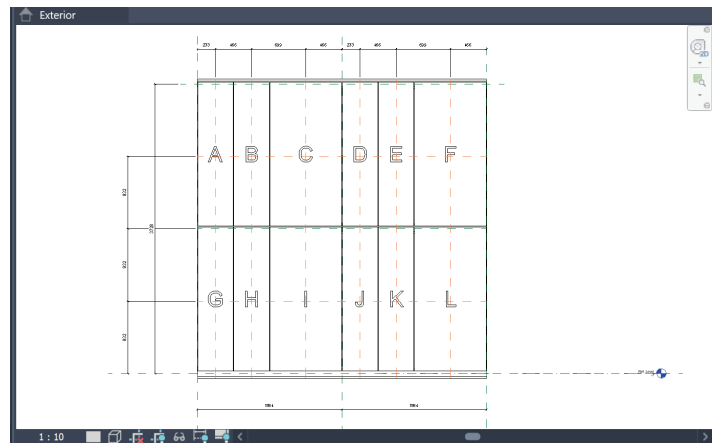
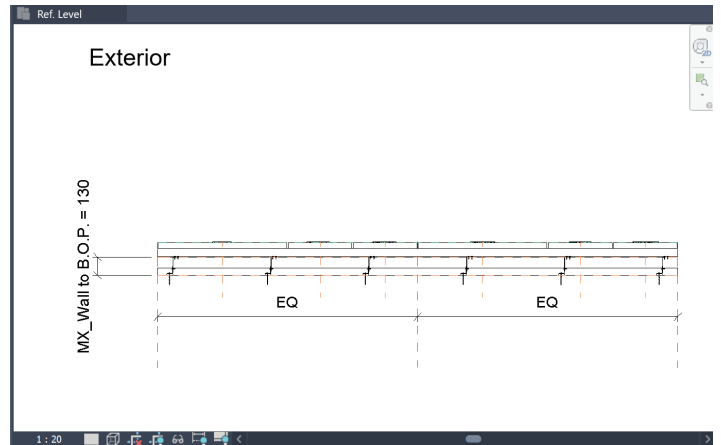

Based on the BIM workflow, choose the category, and then based on the design, choose the family.

eFacade LITE Design Tool Revit visualization

Generic Model Family Usage Steps

1. **Download The BIM Catalog File:** Go to <https://www.mitrex.com/resources/certifications-downloads> and look for the **eFacade LITE BIM Catalog zip file**

▶ Take a look at Video -02

2. **Load the Generic Model Family:** Open the Revit project and load the Generic Model family.

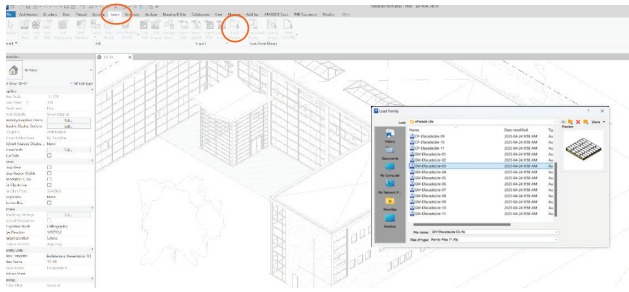

3. **Place the Family on the Facade:** Select the family and place it on the facade where desired. This family is a face-based generic model, so when taking it on the face of walls or other models, it automatically chooses its host.

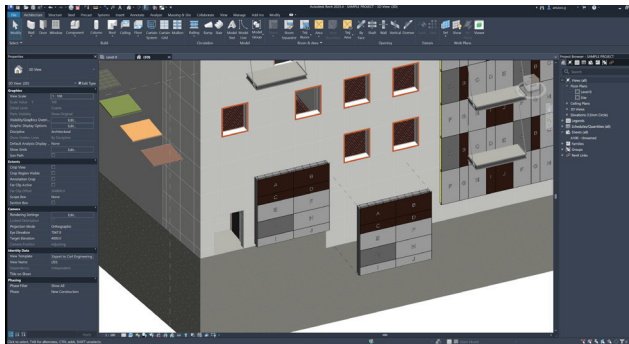

4. **Adjust the Placement:** by using Align tool, align the panel to the existing models.

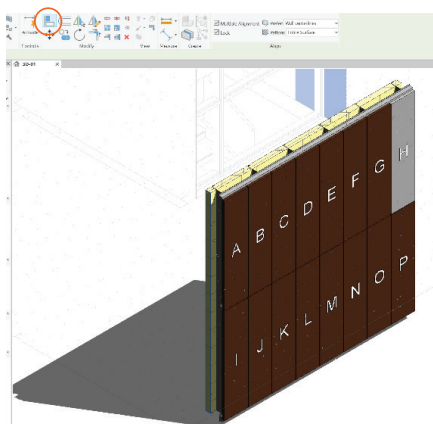

5. **Apply Materials:** Assign the appropriate materials to the tiles to match the design specifications.

1. First select the family
2. Click on the Type Properties
3. Each tile has an alphabetical tag which you can find it in the Type properties and change it to the desired color.

▶ Take a look at Video -03

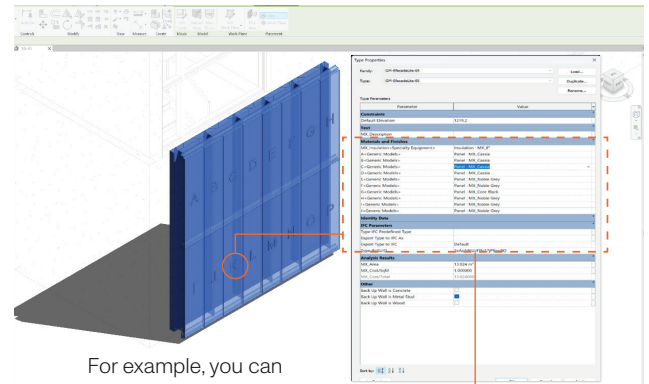

For example, you can change tile "K" from here

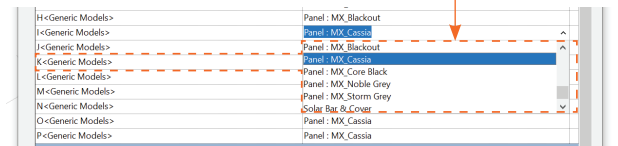

Available Colours: After clicking on each drop down menu in front of the tags, choose the color between these 5 options:

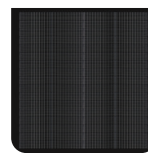

Core Black
⚡ 18W/SQFT



Blackout
⚡ 16W/SQFT



Nobel Grey
⚡ 10W/SQFT



Storm Grey
⚡ 13W/SQFT

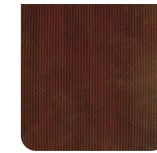

Cassia
⚡ 14W/SQFT

6. Inserting Wall Information: Insert the information about the wall where the panel will be sitting on and the type of Insulation.

The 'Type Properties' dialog box for 'GM eFacadeLite-11' is shown. The 'Materials and Finishes' section is expanded, showing 'Insulation: MX_4"'. A red dashed box and arrow point to this section with the text 'Select the type of Insulation'. The 'Identity Data' section is expanded, showing 'MX_Wall to B.G.P.'. A red dashed box and arrow point to this section with the text 'Select wall-to-panel dimension'. The 'IFC Parameters' section is expanded, showing 'MX_Cost/SqM'. A red dashed box and arrow point to this section with the text 'Select one of these parameters as the wall base type'. The 'Other' section is expanded, showing 'Back Up Wall is Concrete', 'Back Up Wall is Metal Stud', and 'Back Up Wall is Wood'. A red dashed box and arrow point to these options with the text 'Select one of these parameters as the wall base type'. The 'OK' button is highlighted at the bottom right.

7. Turning tags off: After choosing the color of the tiles, turn off the tags from here:

The 'Modify | Generic Models' dialog box is shown. The 'Visibility' section is expanded, showing 'MX Panel Tag Visibility' with a checked checkbox. A red dashed box highlights this checkbox. The background shows a 3D model of a wall with blue panels labeled A through P.

Curtain Panel Family Usage Steps

1. **Download The BIM Catalog File:** Go to <https://www.mitrex.com/resources/certifications-downloads> and look for the **eFacade LITE BIM Catalog zip file**

▶ Take a look at Video -04

2. **Load the Curtain Panel Family:** Open a Revit project and load the Curtain Panel family desired.

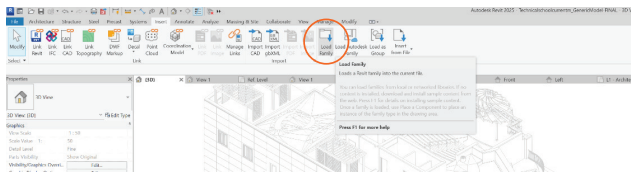

3. **Create a Curtain Wall:** If there isn't an existing curtain wall in the project, create one by selecting the 'Curtain Wall' tool and drawing it on the facade. Adjust the wall size and location as needed.

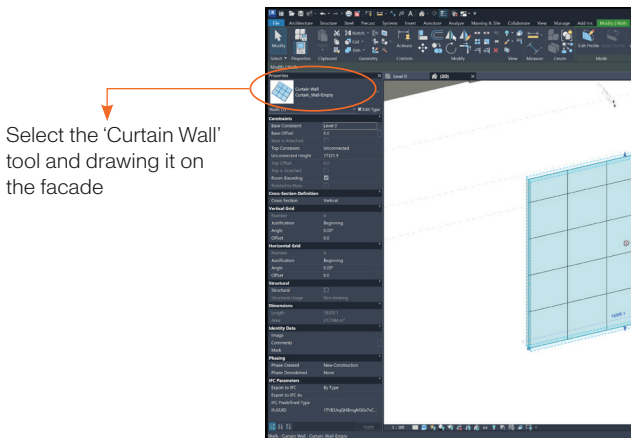

Select the 'Curtain Wall' tool and drawing it on the facade

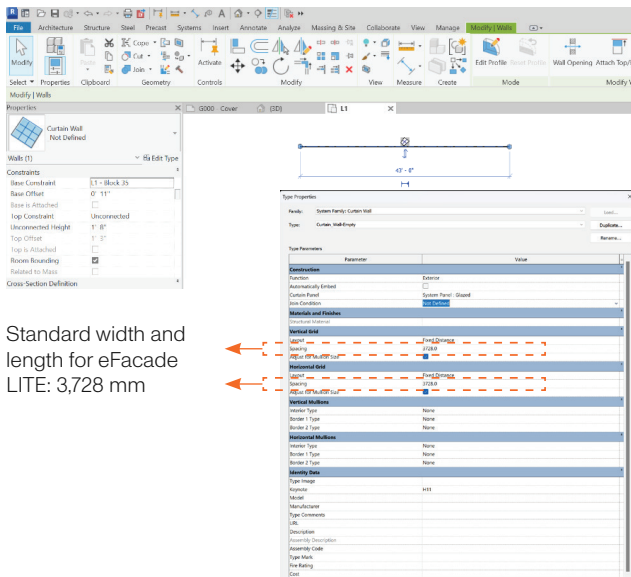

Standard width and length for eFacade LITE: 3,728 mm

4. **Implement the Families:** Select the curtain panels and change them to the desired family type from the eFacade LITE selection.

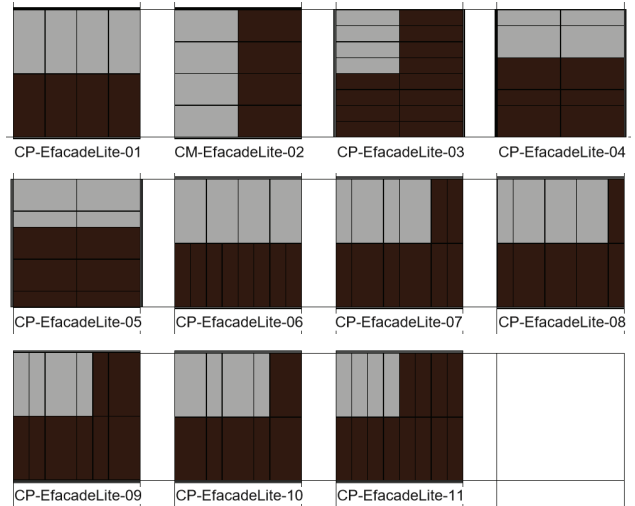

5. **Apply Materials:** Assign the appropriate materials to the tiles to match the design specifications.

1. First select the family
2. Click on the Type Properties
3. Each tile has an alphabetical tag which you can find it in the Type properties and change it to the desired color.

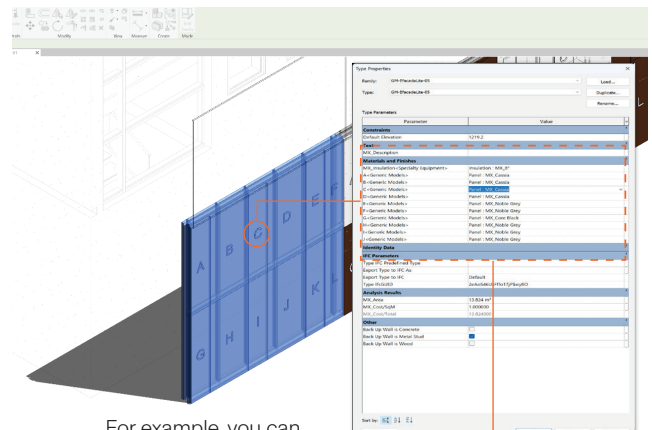

For example, you can change tile "C" from here

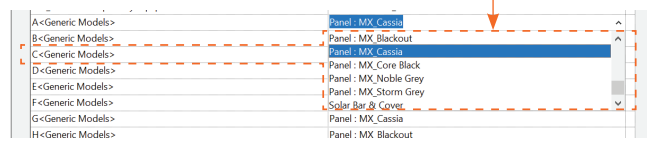

Curtain Panel Family Usage Steps

Implement the Families: Select the curtain panels and change them to the desired family type

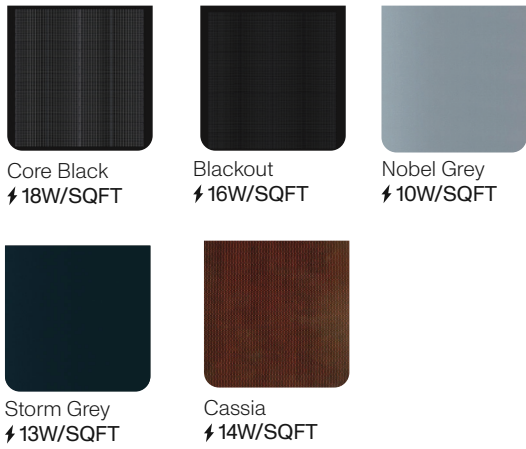

6. Inserting Wall Information: Insert the information about the wall where the panel will be sitting on and the type of Insulation.

[Take a look at Video -05](#)

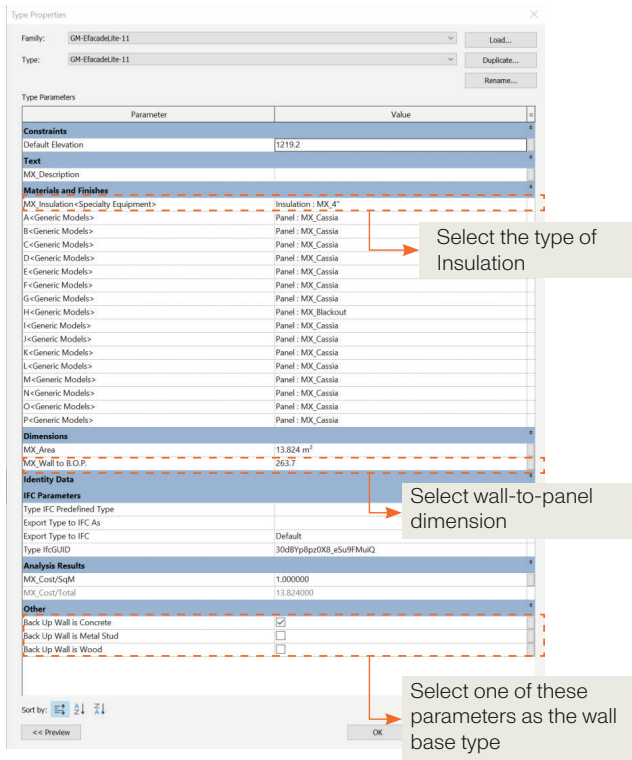

7. Turning tags off: After choosing the color of the tiles, turn off the tags from here:

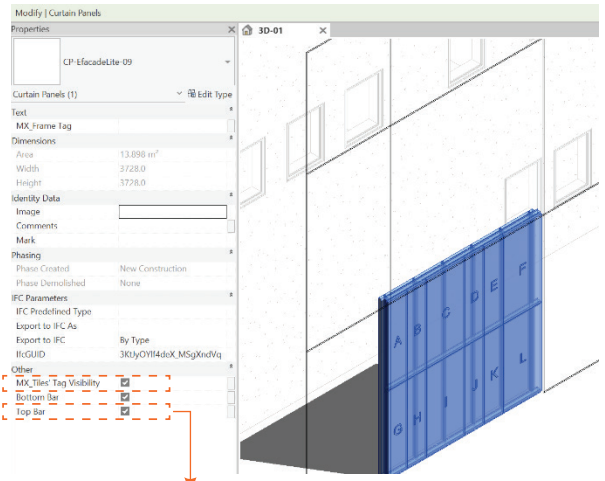

To prevent bar overlaps while applying curtain panels, disable them from this menu.

Create Schedules for Cost Estimates

1. **Create a New Schedule:** Go to the View Tab → Navigate to the “View” tab on the ribbon → Select Schedules → Click on “Schedules” → Then choose “Schedule/Quantities.”

2. **Choose the Category:** In the “New Schedule” dialog box, select “Generic Models”, “Curtain Panel” or “Multi Category” from the category list.

3. **Define Fields:** In the “Schedule Properties” dialog, go to the “Fields” tab → Add the fields desired to include in the schedule. Common fields include:

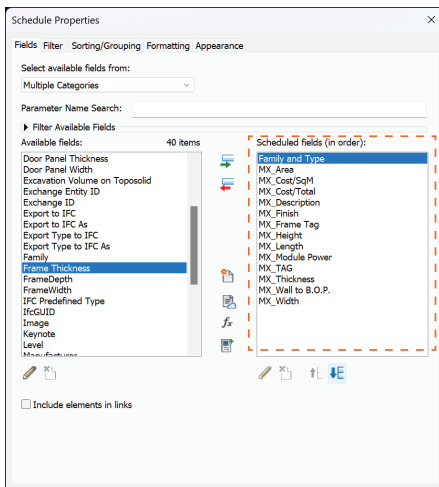

4. **Filter Data:** In the Filter tab follow the picture below:

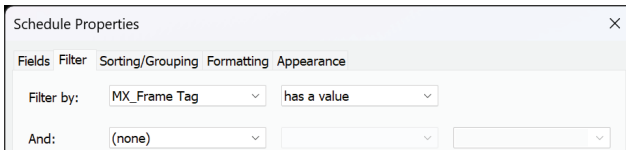

5. **Sort and Group**

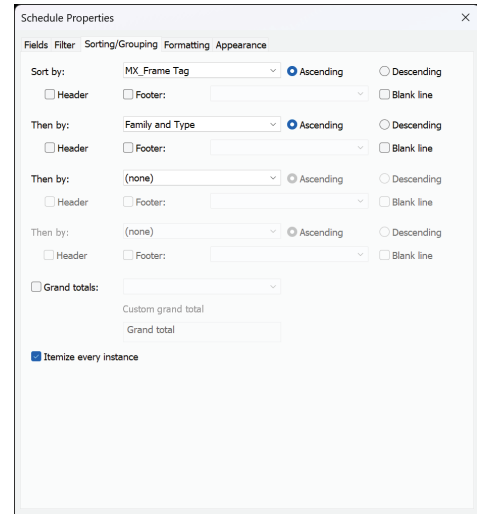

6. **Finish and Place The Schedule:**

Multi Category Schedule										
	A	B	C	D	E	F	G	H	I	J
	Family and Type	Count	MX_Area	MX_Cost/SqM	MX_Cost/Total	MX_Frame Tag	MX_Height	MX_Length	MX_Width	MX_Thickness
MX_01	CP-Escadit.Ite-01: CP-Escadit.Ite-01	1	14 m ²	1	13.824	MX_01				
	Insulation: MX_F	1	14 m ²			MX_01	3728		3728	51
	Panel: MX_Curtain	4	2 m ²			MX_01	1954		922	41
	Panel: MX_Mobile Grey	4	2 m ²			MX_01	1954		922	41
	Solar Bar B Cover: Solar Bar B Cover	3				MX_01		3728		
	MX_02									
	CP-Escadit.Ite-01: CP-Escadit.Ite-01	1	14 m ²	1	13.824	MX_02				
	Insulation: MX_F	1	14 m ²			MX_02	3728		3728	51
	Panel: MX_Curtain	4	2 m ²			MX_02	1954		922	41
	Panel: MX_Mobile Grey	4	2 m ²			MX_02	1954		922	41
	Solar Bar B Cover: Solar Bar B Cover	3				MX_02		3728		
	MX_03									
	CP-Escadit.Ite-01: CP-Escadit.Ite-01	1	14 m ²	1	13.824	MX_03				
	Insulation: MX_F	1	14 m ²			MX_03	3728		3728	51
	Panel: MX_Curtain	4	2 m ²			MX_03	1954		922	41
	Panel: MX_Mobile Grey	4	2 m ²			MX_03	1954		922	41
	Solar Bar B Cover: Solar Bar B Cover	3				MX_03		3728		
	MX_04									
	CP-Escadit.Ite-11: CP-Escadit.Ite-11	1	14 m ²	1	13.824	MX_04				
	Insulation: MX_F	1	14 m ²			MX_04	3728		3728	51
	Panel: MX_Curtain	12	1 m ²			MX_04	1954		456	41
	Panel: MX_Mobile Grey	4	1 m ²			MX_04	1954		456	41
	Solar Bar B Cover: Solar Bar B Cover	3				MX_04		3728		
	MX_05									
	CP-Escadit.Ite-10: CP-Escadit.Ite-10	1	14 m ²	1	13.824	MX_05				
	Insulation: MX_F	1	14 m ²			MX_05	3728		3728	51
	Panel: MX_Curtain	6	-varies-			MX_05	1954		-varies-	41
	Panel: MX_Mobile Grey	4	-varies-			MX_05	1954		-varies-	41
	Solar Bar B Cover: Solar Bar B Cover	3				MX_05		3728		
	MX_06									
	CP-Escadit.Ite-10: CP-Escadit.Ite-10	1	14 m ²	1	13.824	MX_06				
	Insulation: MX_F	1	14 m ²			MX_06	3728		3728	51
	Panel: MX_Curtain	6	-varies-			MX_06	1954		-varies-	41
	Panel: MX_Mobile Grey	4	-varies-			MX_06	1954		-varies-	41
	Solar Bar B Cover: Solar Bar B Cover	3				MX_06		3728		
	MX_07									
	CP-Escadit.Ite-10: CP-Escadit.Ite-10	1	14 m ²	1	13.824	MX_07				
	Insulation: MX_F	1	14 m ²			MX_07	3728		3728	51
	Panel: MX_Curtain	6	-varies-			MX_07	1954		-varies-	41
	Panel: MX_Mobile Grey	4	-varies-			MX_07	1954		-varies-	41
	Solar Bar B Cover: Solar Bar B Cover	3				MX_07		3728		

NOTE: Before Scheduling, give a value to “MX_Frame Tag” which is assigned to all Curtain Panel and Generic Model Families.



Download the BIM catalogue [HERE](#) or scan the QR code below

- **Toll Free**

+1 (855) 254 0214

- **Learn More**

mitrex.com

info@mitrex.com

- **Headquarters**

41 Racine Rd, Toronto, ON M9W2Z4, Canada

+1 (416) 497 7120

- **USA Office**

Chrysler Building, 405 Lexington Avenue Floor 26, New York, USA, 10174

+1 (646) 583 4486